

# Existing Conditions

## Key Findings



### 1. Building Outages

#### Building Vulnerability Factors

- Location within floodplains
- Basement below grade and in floodplain
- Age of infrastructure
- Location of boiler, mechanicals, and electrical service
- Backup generation capacity
- Perishable contents
- Elevators that require power for apartment access
- Water tank that require power for water service

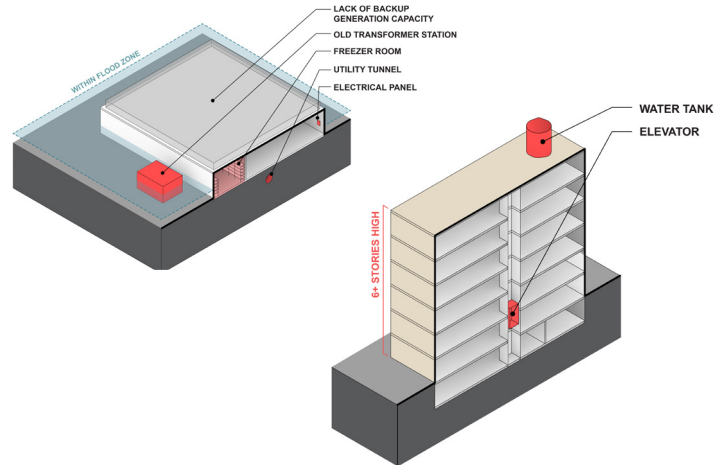

### 2. Coastal Flooding Risk

Due to considerable elevation change, the low-lying industrial area is very vulnerable to coastal flooding. Coastal flooding is not a threat to the upland residential area.

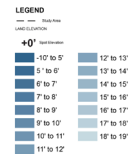
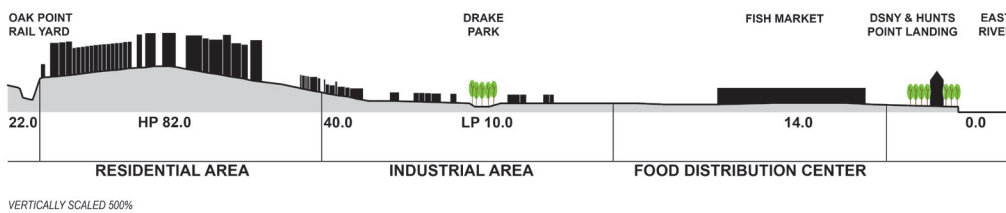

### 3. Precipitation Risk

Flooding from rain and snow is not a major threat in Hunts Point.



### 4. Social Resiliency

While residents still face many socioeconomic inequities, the density of community organizations and capacity for organizing in Hunts Point can enable strong social resiliency.