



Water Table

Jerome W. Haferd

107th St. Pier and Bobby Wagner Walk
Reconstruction Project.

04 Apr 2024
CB-11 Design Presentation

Team (concept design phase) :
Jerome Haferd (lead)
assisted by:
Gabriel Moyer-Perez,
Pedro Cruz-Cruz

*Note : Design (especially engravings/etchings) will be impacted
by community contributions and is subject to change. Etchings shown are placeholder.

PROJECT DESCRIPTION : WATER TABLE



Water Table celebrates the water's edge as a place of **gathering, celebration, and repair**. This permanent artwork will image the archaeology and everyday water stories of El Barrio / East Harlem, while re-surfacing an archaeological trace of the original Harlem Creek which once flowed into the East River at this location, and now lies buried.

The Water Table evokes weaving and water in ancient and futuristic ways. The piece is a work of landscape art, a community engagement concept, and public infrastructure. Water Table will inscribe and activate a crescent-shaped plaza that will embrace the entire esplanade for gathering and everyday ritual at the water's edge.

The artwork consists of three major elements : The groundwork of precast "strands", the precast "altar" which the strands flow across, and the crescent shaped screen made of CNC-cut steel elements.

The Water Table's steel and precast concrete design **weaves our collective histories into a gathering space** and collective statement that resonates not only our human, indigenous relationship to the Water, but also celebrates the diasporas and peoples that gather and have gathered at this specific site and continue to do so today. The Water Table also is an act of joy, abundance, and community, and will serve as a playful and vibrant representation of the revitalization of this Waterfront, displaying "etched" contributions by numerous cultural and community actors from East Harlem.

JEROME HAFERD STUDIO, PREVIOUS PUBLIC WORKS



Tropical Rotisserie, 2020
w/ Felix, Dexter Ciprian



Sankofa, Harlem, 2023



Drum Arbor, Harlem, 2021



Caesura, Harlem, 2015

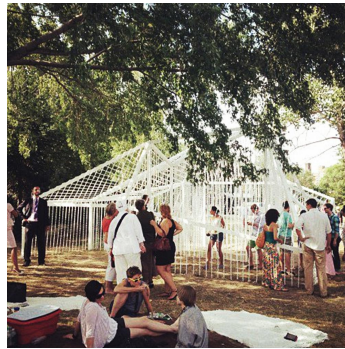

Curtain, Astoria, 2012



Migrate, Harlem, 2020-21

JEROME HAFERD STUDIO, PREVIOUS PUBLIC WORKS



Sankofa, Jerome Haferd, 2023

NAME: East River

PROJECT: Water Table / 107th BWW Esplanade



JEROME HAFERD STUDIO

TITLE: Previous Public Works

SCALE: NTS

DATE: 01/30/2024

107th Street / BWW Site Plan from Stantec showing Artwork location (Jan 2024)

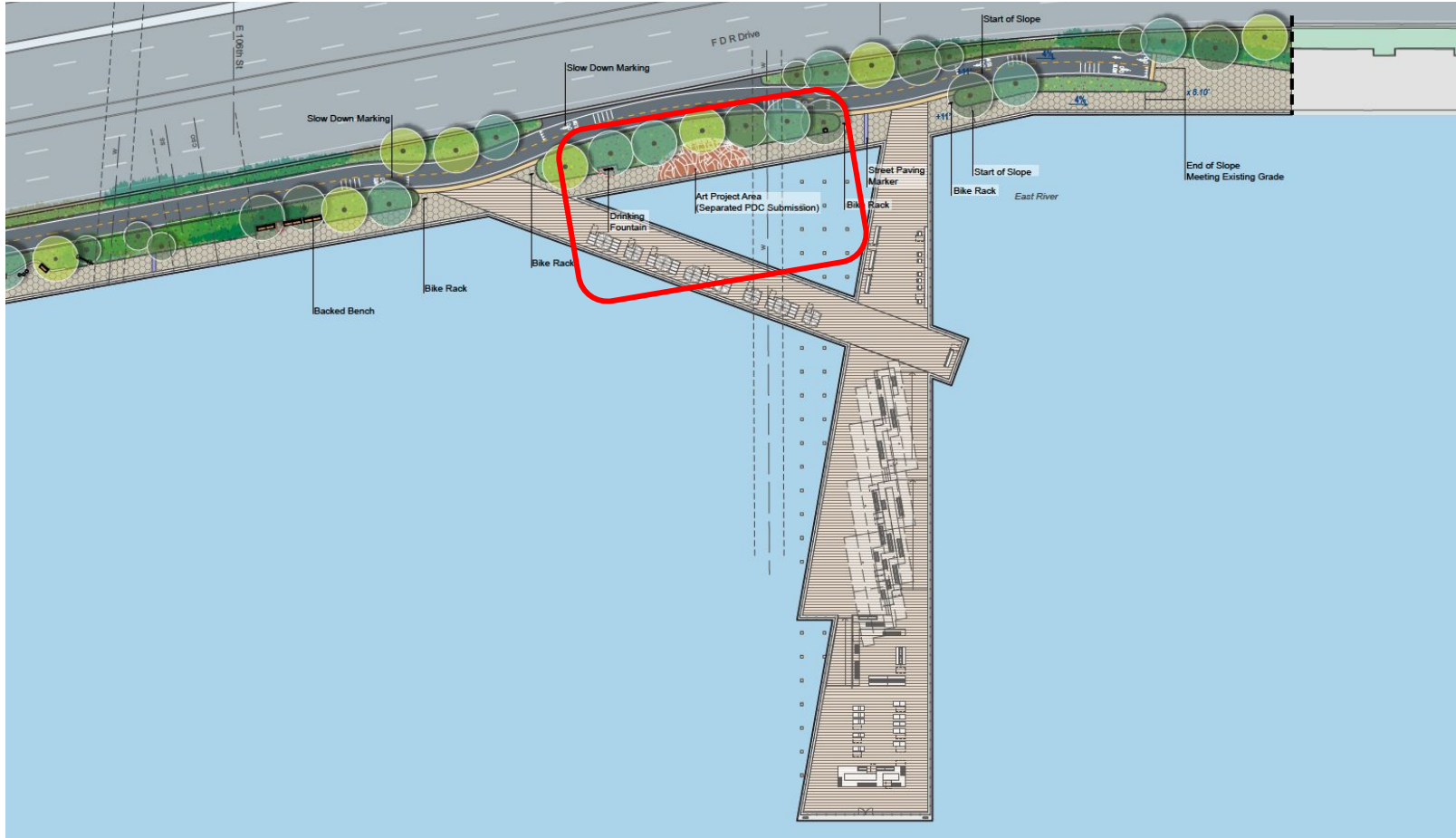

SITE PLAN - ZOOM (from Stantec/Marvel , January 2024)

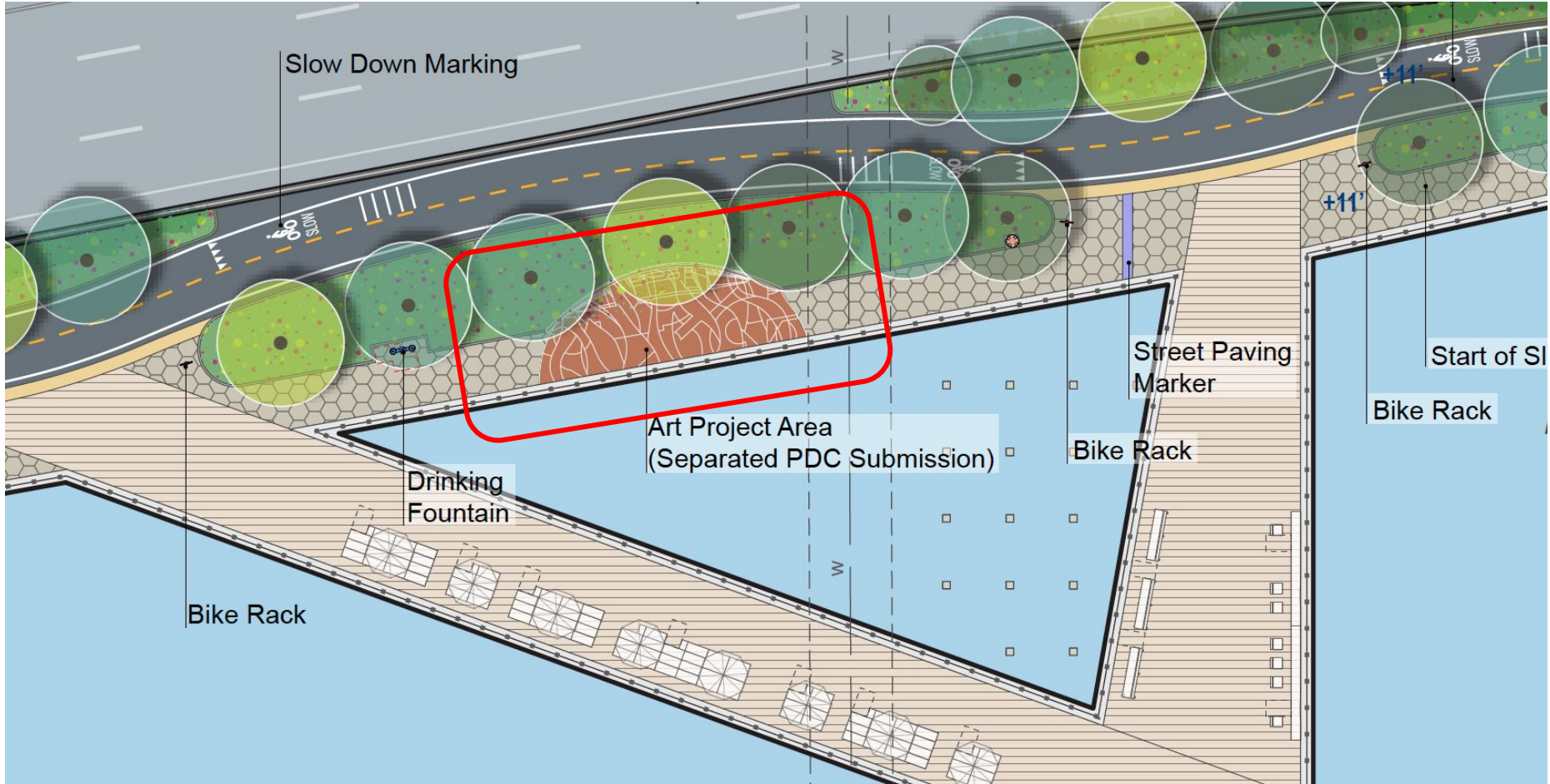

CONCEPT DEVELOPMENT

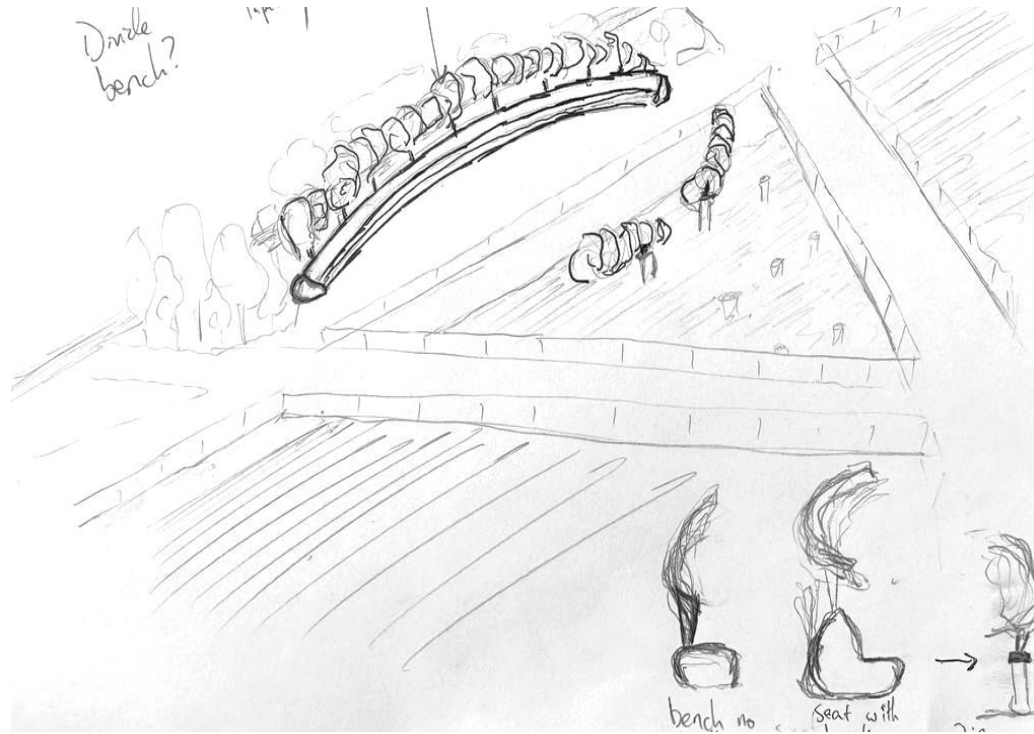

Water Table, process sketches

The **half circle (crescent)** helps define a public plaza or “micro-plaza”
Incorporating a table / altar for folks to gather, relax, “just be”
Integrate motifs and voices into the piece that reflect the community



Sankofa, Jerome Haferd, Harlem, 2023
(previous work)

CONCEPT DEVELOPMENT



“Everyone gathers at the water”

The Water’s Edge is about :

GATHERING

PROCESS

REPAIR

CELEBRATION

All Nations Pow Wow / Gathering, Water Ceremony, Randall's Island, 2022

CONCEPT DEVELOPMENT

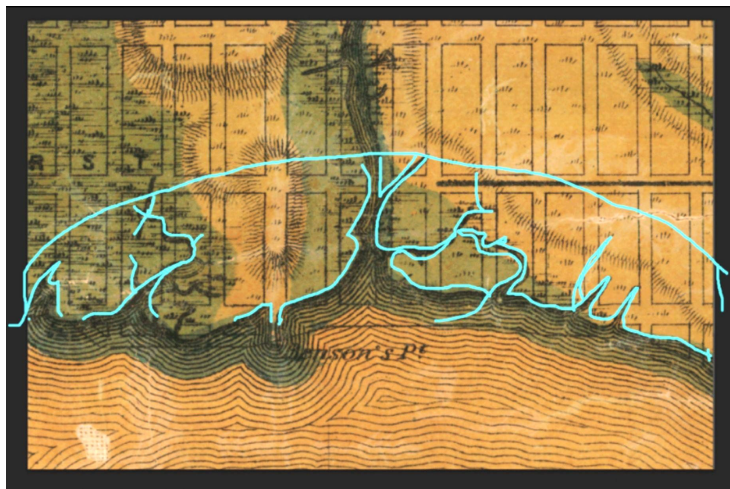
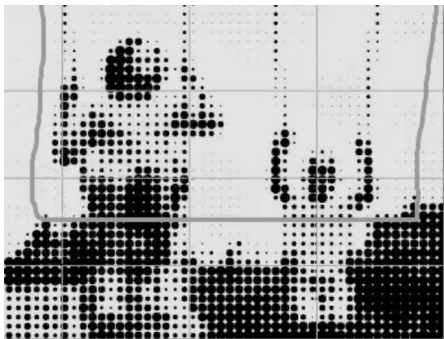

“Everyone gathers at the water”

The Water Table

**PLACE FOR LIBATION, EDUCATION,
“JUST BE”**

IMAGES LOCAL HISTORIES

EVERYDAY WATER STORIES

ARCHAEOLOGY OF HARLEM CREEK

Harlem Creek Archival Images, Viele Map and NYPL archival images

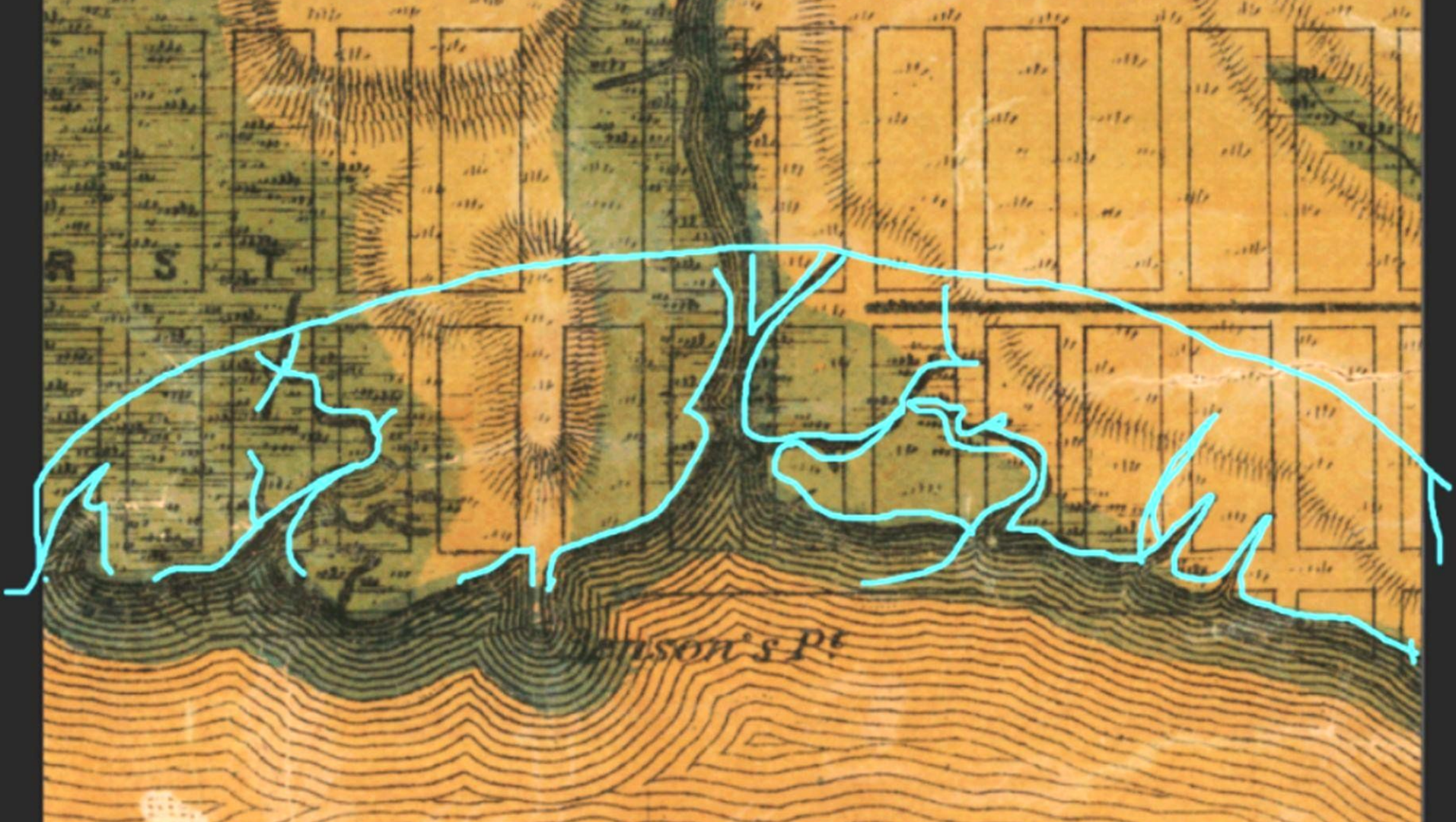

CONCEPT DEVELOPMENT

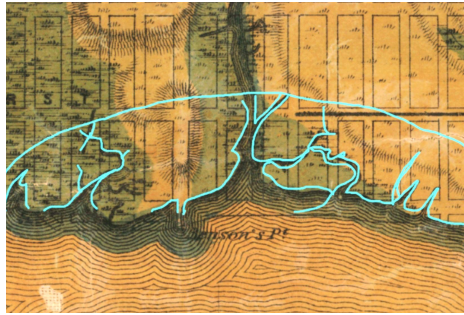
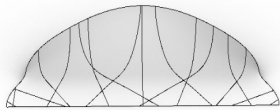
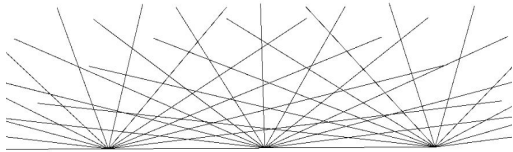
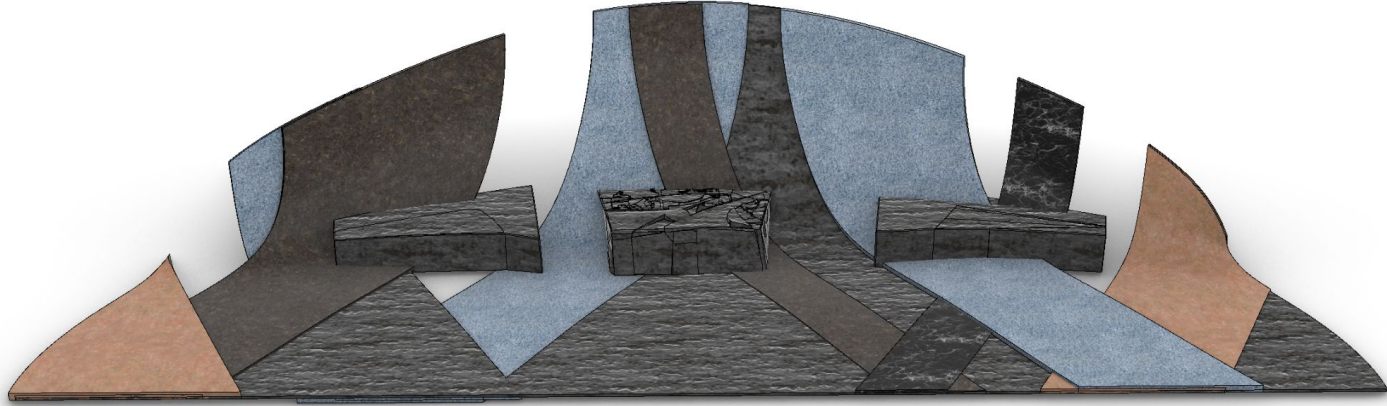

Beadwork on Woman's Legging

This woman's cloth legging is decorated with beadwork with little diamond design similar to what would have been done in ribbonwork. It was more common to decorate the leggings with ribbonwork. This was made about 1970.

**CONCEPT - COMMUNITY ETCHINGS
(DETAIL)**



STEEL - CNC WATERJET CUT



PRECAST PANELS - CNC RUBBER MOLD

ALTAR PRECEDENT - WOMEN'S TABLE (MAYA LIN, NEW HAVEN)



AERIAL VIEW



WATER TABLE - PERSPECTIVE, FRONT VIEW



*Note : Design (especially engravings/etchings) will be impacted by community contributions and is subject to change. Etchings shown are placeholder.

WATER TABLE - TOP (PLAN) VIEW

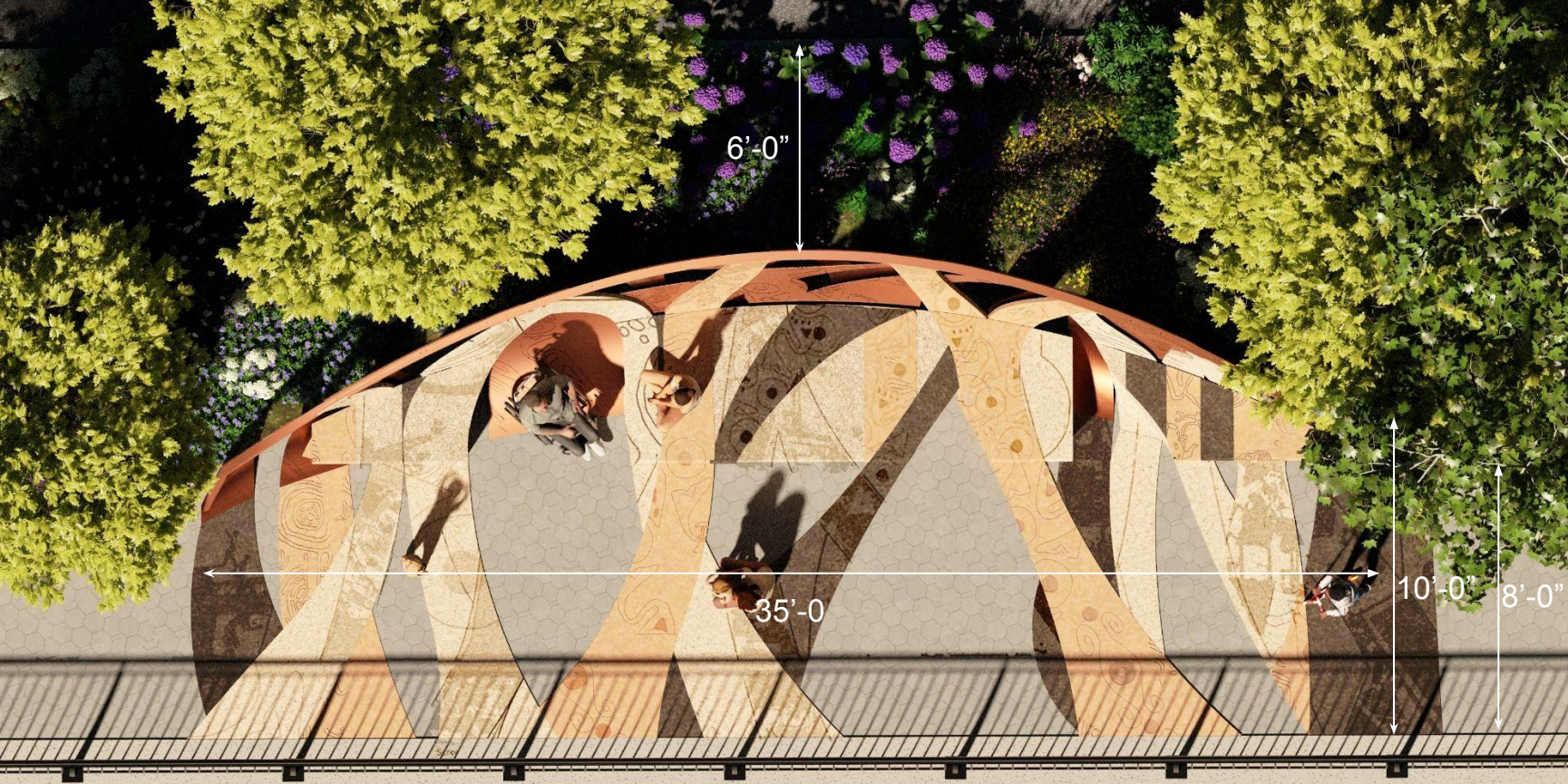

WATER TABLE, PERSPECTIVE VIEW ALONG ESPLANADE W/ NOTES



WATER TABLE, PERSPECTIVE VIEW ALONG ESPLANADE W/ NOTES



.18" steel arch
Box form
(semi-concealed) w/
Tenemec paint

Custom precast
GFRP panel

.5" / .25" alum or steel
fins w/ Tenemec paint
With .5" steel baseplate

"Altar"
Custom GFRP precast
Panel facing (~3" thick)

Custom Precast GFRP
Concrete Inlay pavers
(max dim ~3'-0", max
deviation +/- 1/4")

MAINTENANCE



Painted metal elements -

Additional Tenemec (or equivalent) paint matching the color used for the steel screen elements will be provided to NYCParks and kept in reserve for touch-ups as needed.

Vandalism (graffiti) -

at present, graffiti-resistant coating is not recommended for the structure. However, Arts & Antiquities recommend assessment after install to see if graffiti becomes a chronic issue.

Ground GFRC / precast pavers - Fabricators with experience on this stretch of waterfront assure that GFRC precast concrete panels will be sized and possess high strength to resist breakage from chipping, snowplowing, or regular everyday use.

“Altar” and screen GFRC pavers will have a semi-polish surface treatment which is easy to clean.

More details on the maintenance plan will be shared during the submission for Preliminary Review.

WATER TABLE - CONCEPT ASSEMBLY DIAGRAM

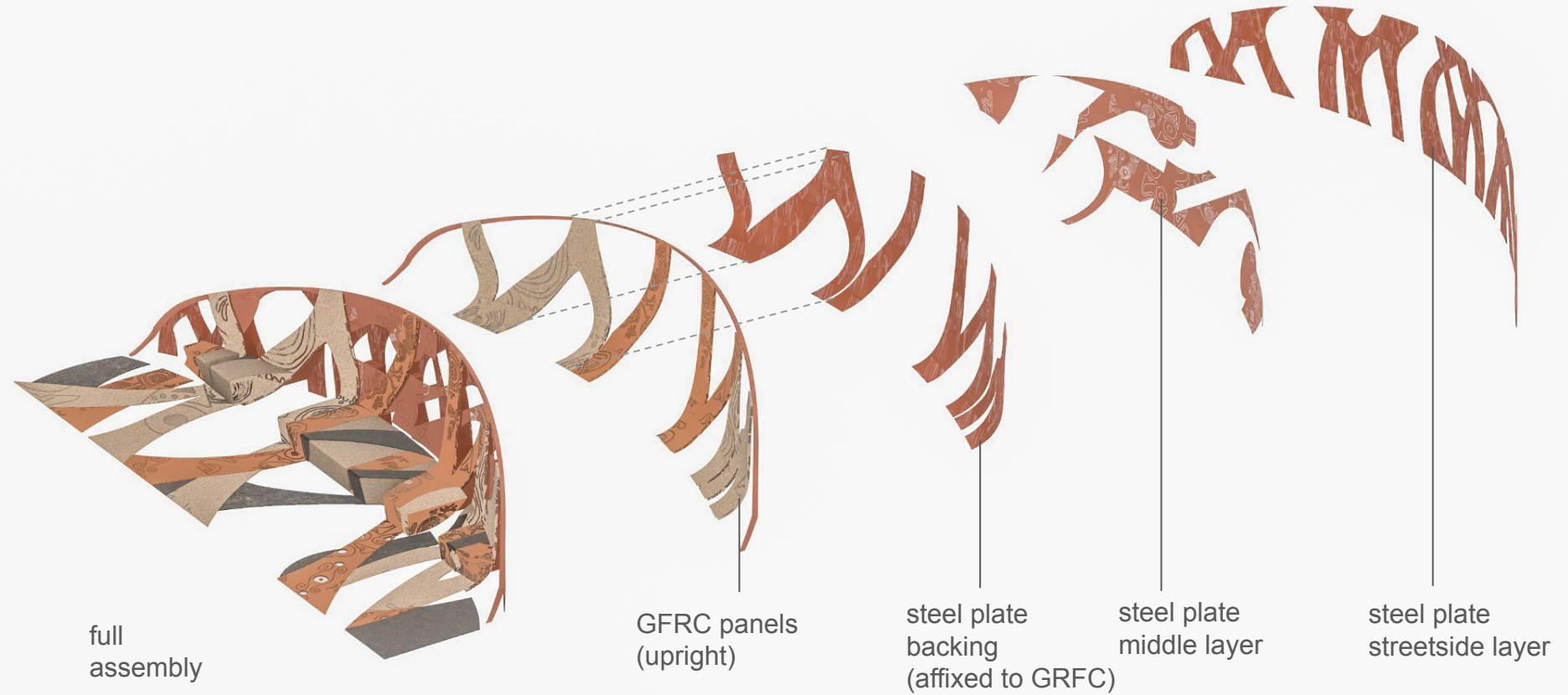

CONCEPTUAL PHASE SECTIONS - PRELIMINARY AND SUBJECT TO CHANGE

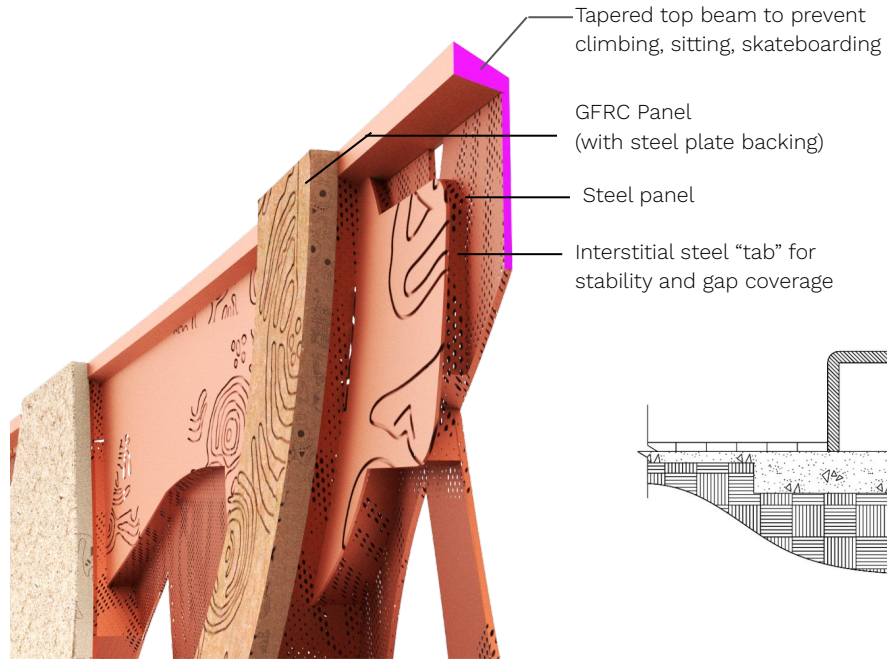

Detail section perspective

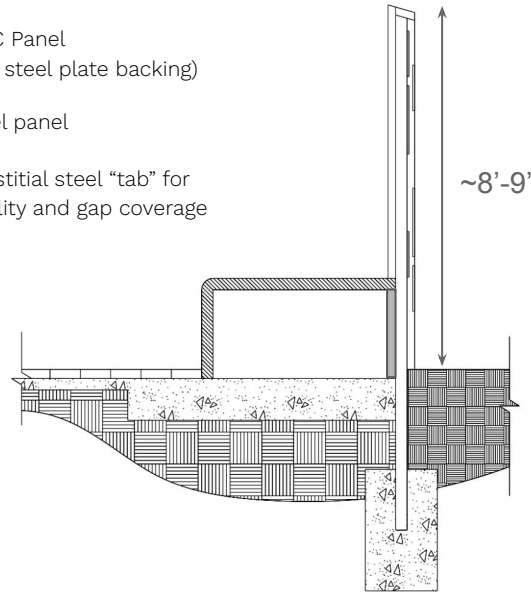

Section showing steel back panel

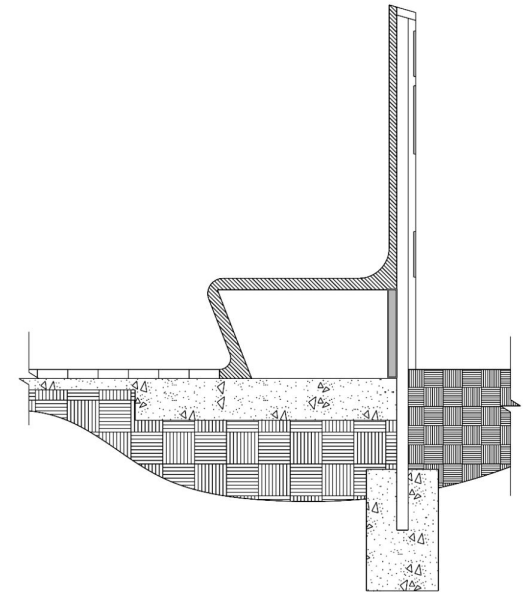

Section showing steel + GFRC back panel

WATER TABLE - PERSPECTIVE VIEW FROM BIKE PATH



NAME: East River

PROJECT: Water Table / 107th BWW Esplanade

JEROME HAFERD STUDIO

TITLE: Renderings

SCALE: NTS

DATE: 01/30/2024

PRECAST / GFRC EXAMPLES

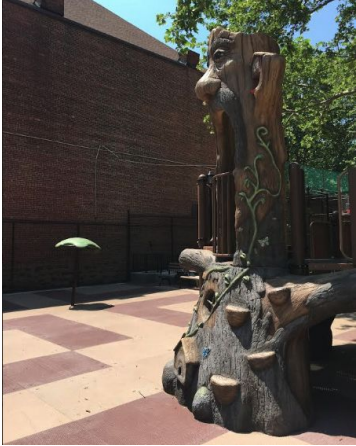

CW
EAST
CONCRETEWORKS EAST



NAME: East River

PROJECT: Water Table / 107th BWW Esplanade

JEROME HAFERD STUDIO

TITLE: Construction Notes

SCALE: NTS

DATE: 01/30/2024

WATER TABLE - ADDITIONAL VIEWS, REAR



COMMUNITY ENGAGEMENT PROCESS

Open to All and Inclusive!

Some Potential Collaborators in our community :

Central Park East

RSA Academy

Metropolitan Hospital

Manhattan East School for Arts & Academics

Museo El Barrio / PS109 ArtSpace

Friends of East River Esplanade

Union Settlement

East Harlem Preservation

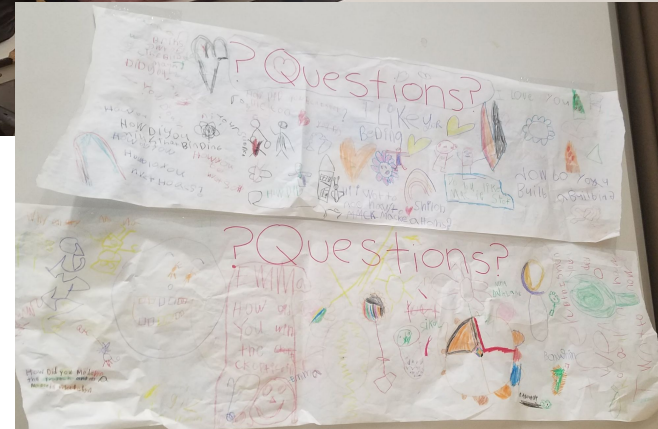

EXAMPLE DIGITIZED “ETCHING” EXAMPLE

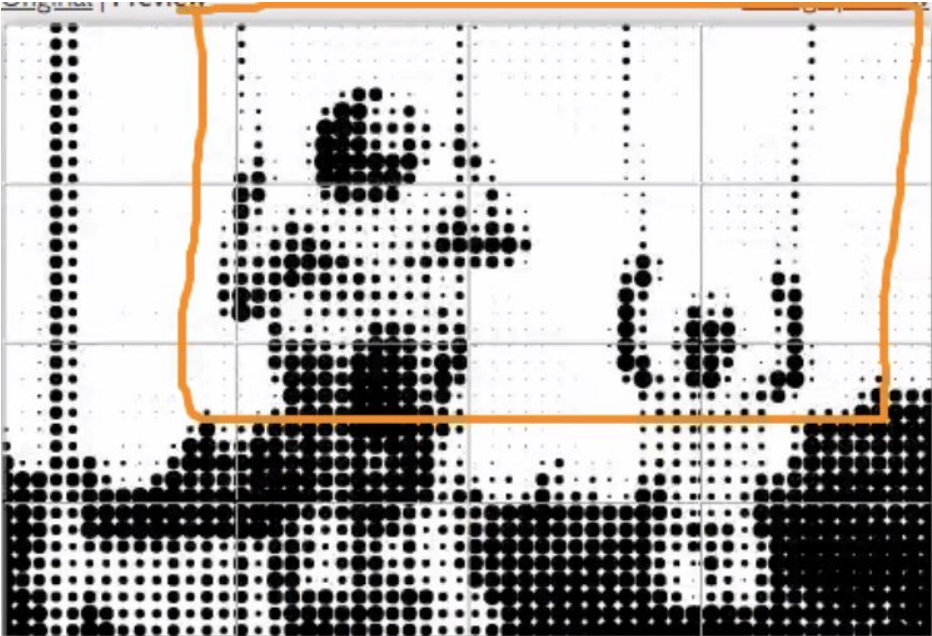

EXAMPLE ETCHING EXAMPLES

Community Contribution Process :
Example ways to Participate / Contribute :

Share your Water (or other) Story :

Make / Contribute a **Drawing**

Express / Write some **Words**

Share an **Image / Photograph**

Make a **Collage** or
Something Else with Supplies (Provided)!

(remote / email submission TBC), submissions will be selected,
digitized, and composed by Jerome Haferd team

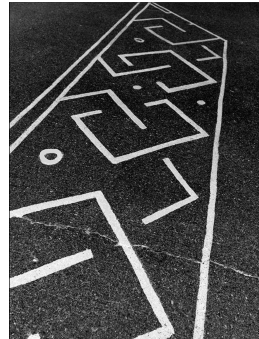
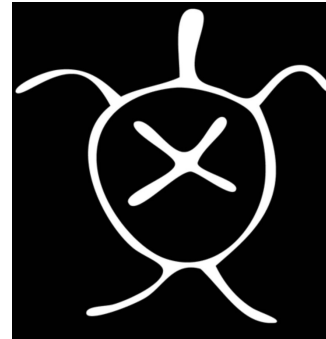

Taino Water Symbols, MÚKARO BORRERO,
Taino Confederation / Community member

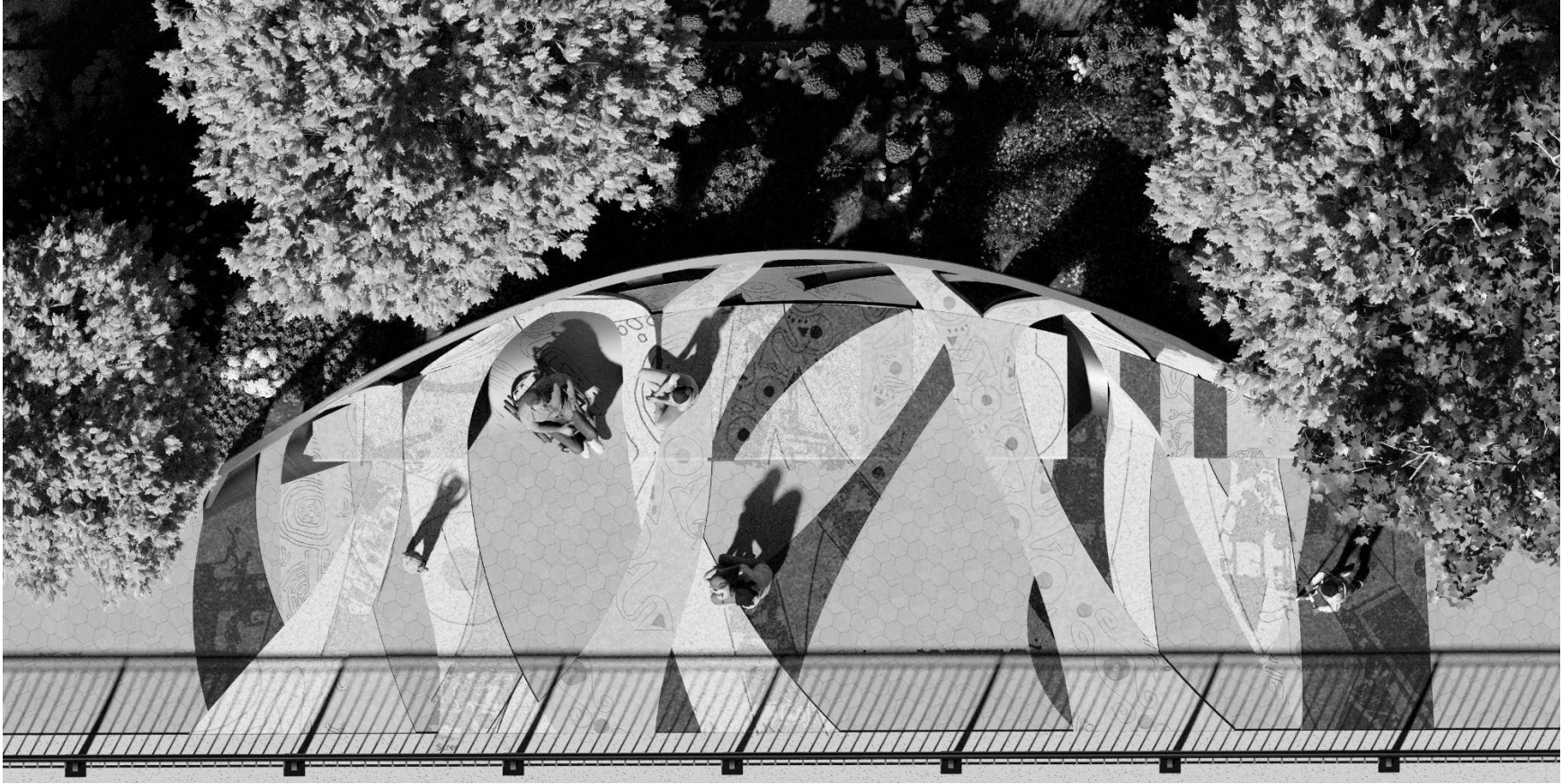

APPENDIX -

Additional Process Drawings and Supplemental Material

ALTERNATE STRANDS ITERATION



WATER TABLE - ALTERNATE STRAND VARIATION STUDY "CRISS-CROSS"



SPACER / PROPOSED GAP CLOSE DETAIL

SPACER / PROPOSED GAP CLOSE DETAIL

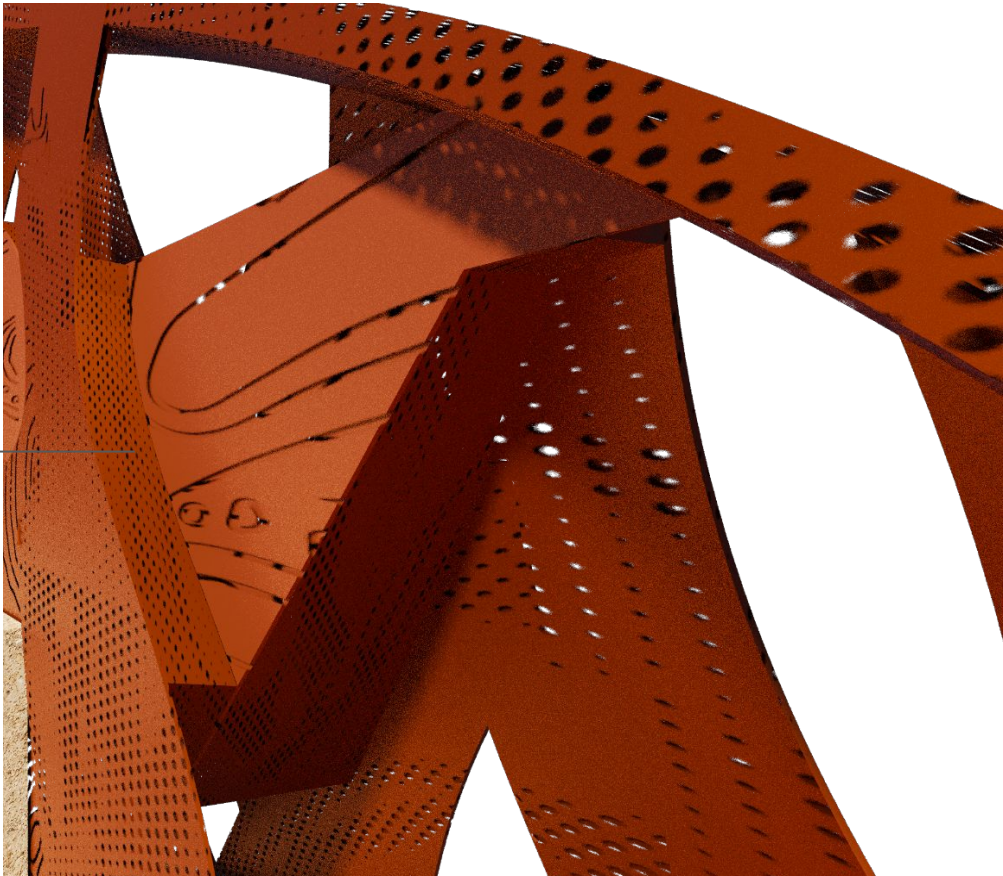

SIDE VIEW / SECTION (OUTDATED DESIGN SHOWN)

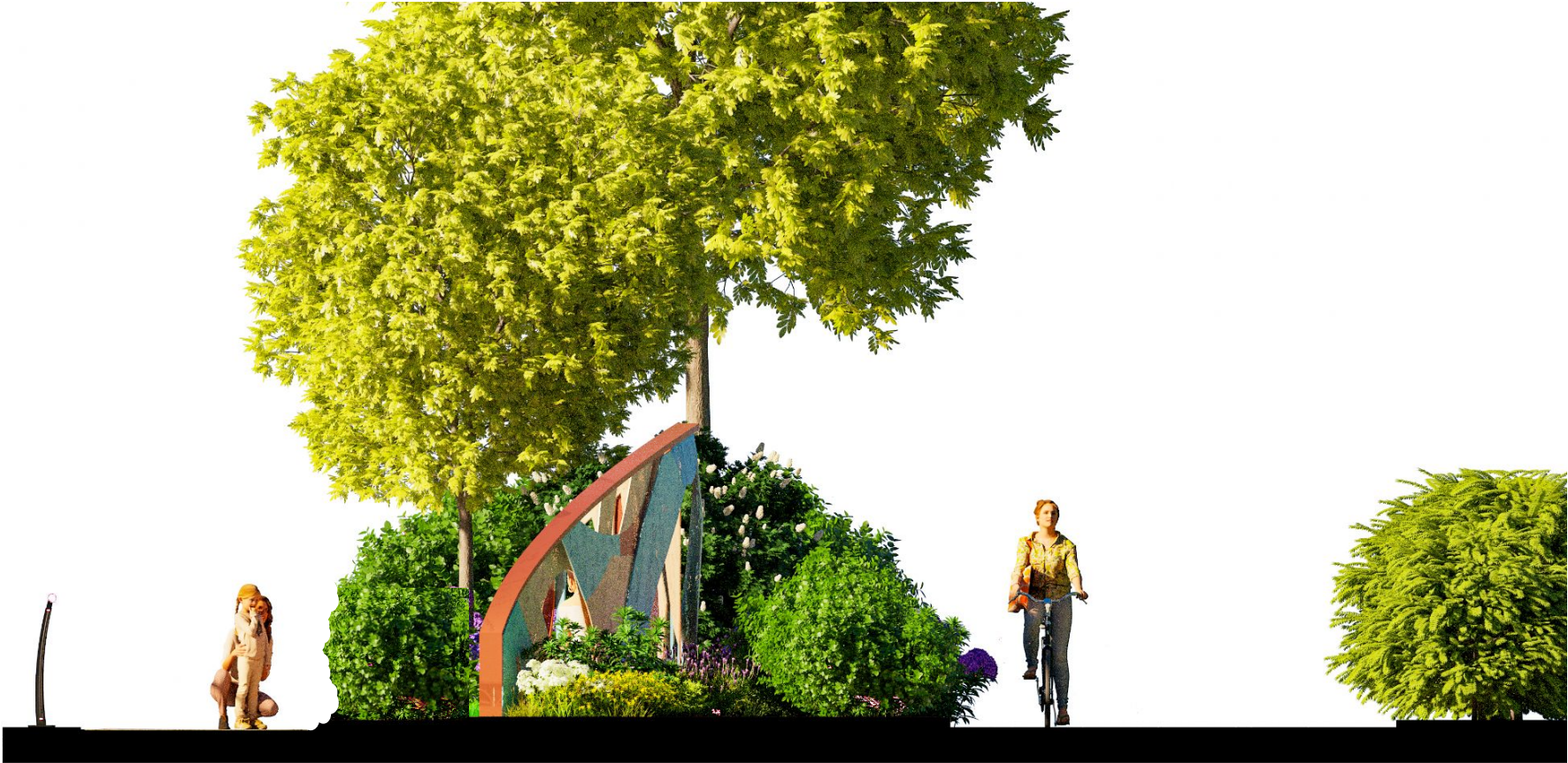

EVENING PERSPECTIVE SHOWING POSSIBLE GROUND UPLIGHTING (TBD) - OUTDATED DESIGN SHOWN

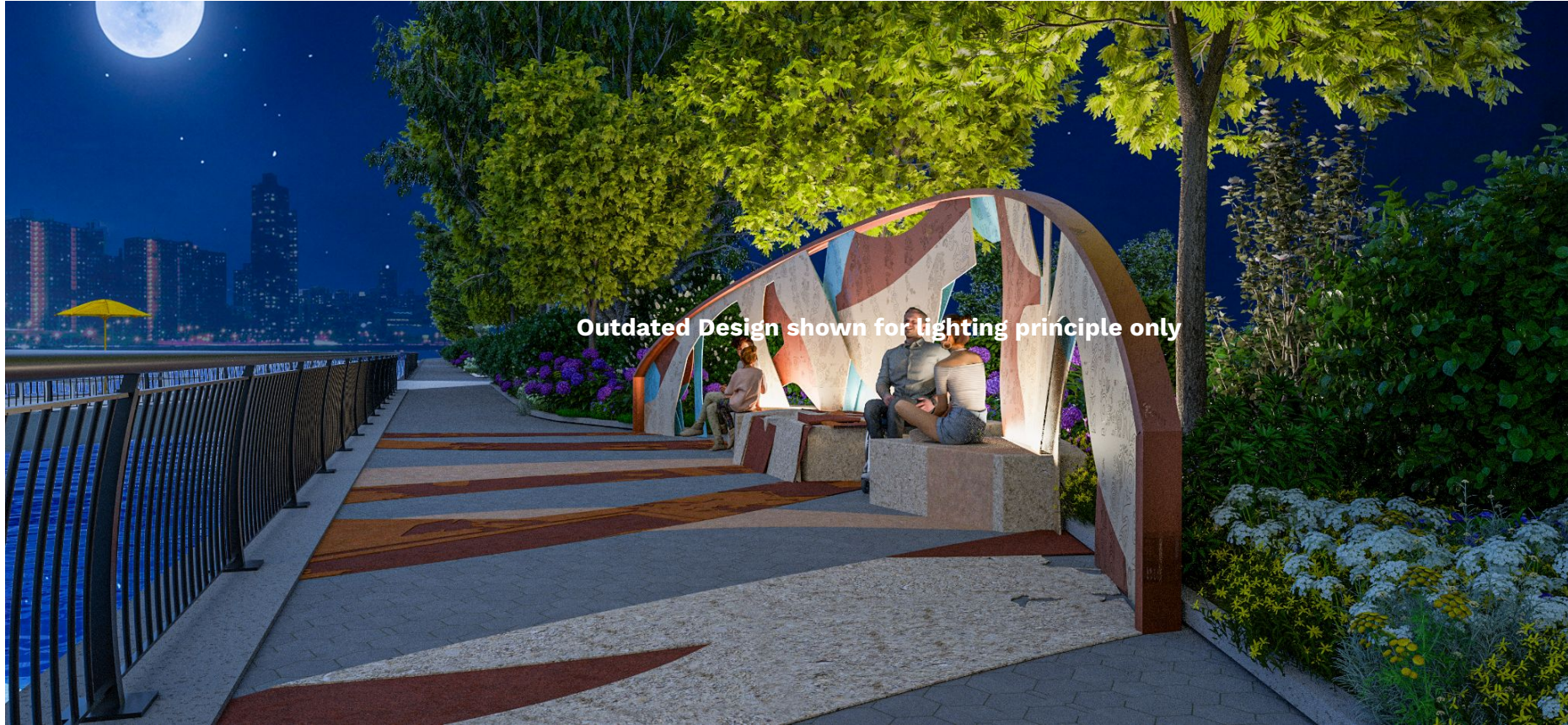

Outdated Design shown for lighting principle only

FABRICATION - CNC STEEL LASER / WATERJET

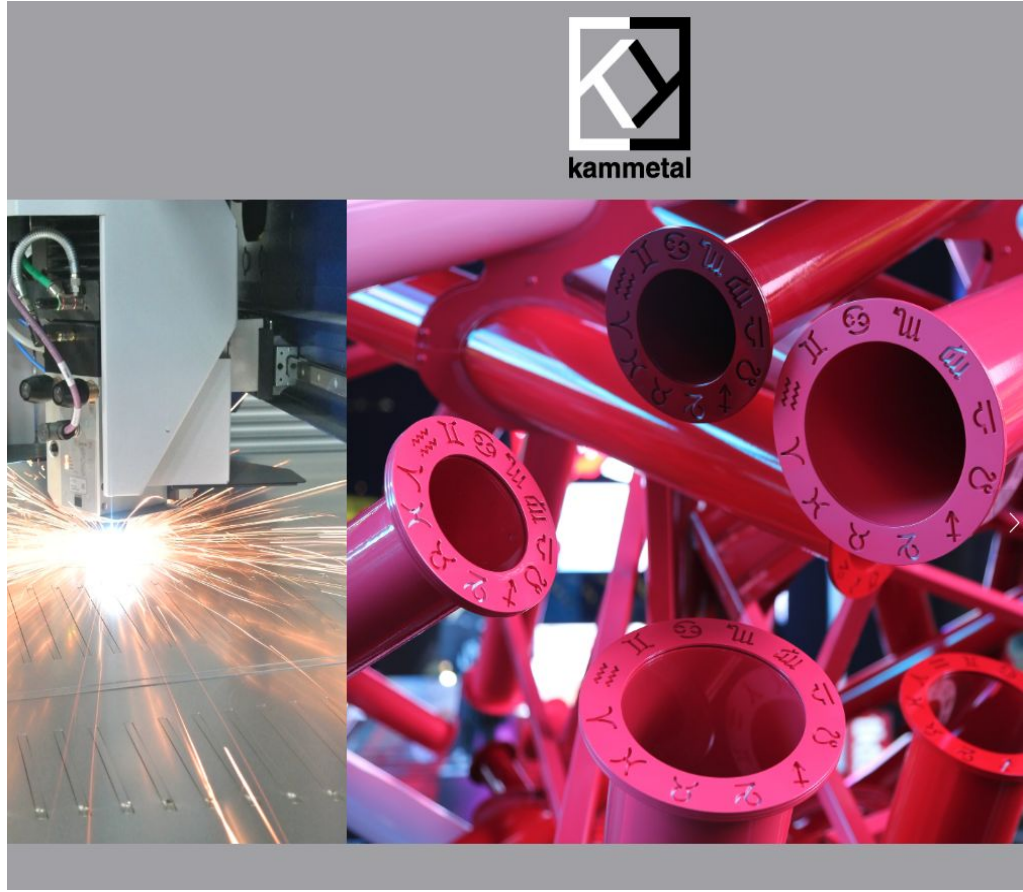
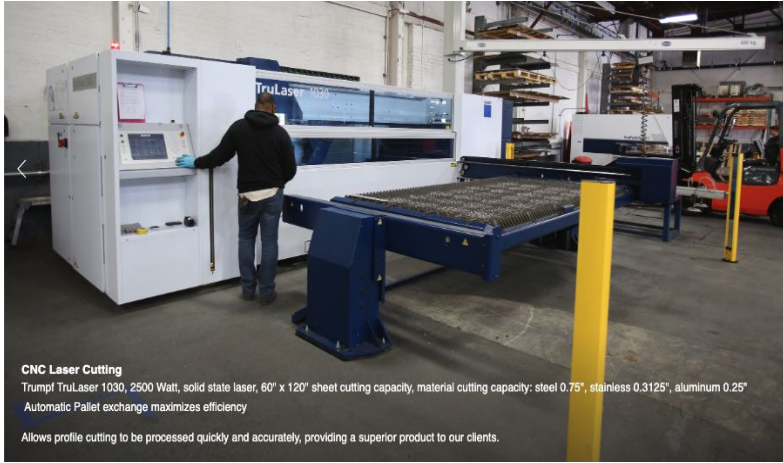

FABRICATION - GFRC COLOR PALETTE



NAME: East River

PROJECT: Water Table / 107th BWW Esplanade



JEROME HAFERD STUDIO

TITLE: Construction Notes

SCALE: NTS

DATE: 01/30/2024

COMMUNITY ENGAGEMENT PROCESS

DRAFT STRATEGY / TIMELINE :

3 - 4 sessions during Spring / Summer 2024

led / facilitated by Jerome Haferd, with option for submission of content via email (schools, teacher-led drawing session)

6pm-730pm

Locations TBC :

Schools / Dream Academy, Hospital, 345 Artspace

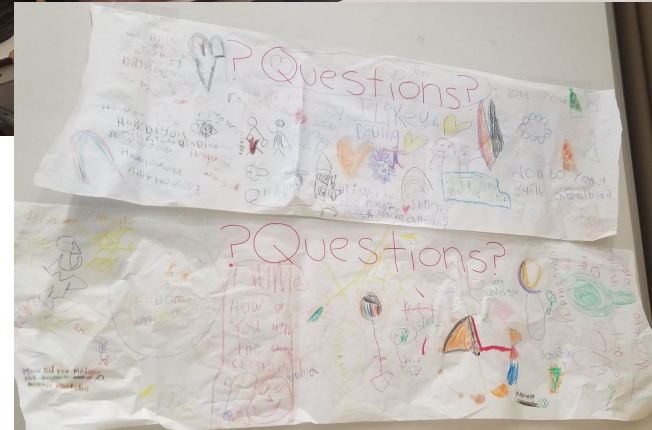

COMMUNITY ENGAGEMENT PROCESS

DRAFT

Community Contribution Prompt :
Example ways to Participate / Contribute :

Share your Water (or other) Story :

Make / Contribute a **Drawing**

Express / Write some **Words**

Share an **Image / Photograph**

Make a **Collage** or
Something Else with Supplies (Provided)!

(remote / email submission TBC), submissions will be selected, digitized,
and composed by Jerome Haferd team